

# 8100 SC 8 Zyklop Metal Ratchet Set with switch lever, 1/2" drive, metric, 28 pieces



## The Zyklop Metal Ratchet Switch, 1/2"



<b>EAN:</b>	4013288173881	<b>Size:</b>	325x145x65 mm
<b>Part number:</b>	05004078001	<b>Weight:</b>	2880 g
<b>Article number:</b>	8100 SC 8	<b>Country of origin:</b>	CZ
		<b>Customs tariff number:</b>	82041100

- Convenient direction change thanks to switchover lever
- Extremely slim ratchet with long lever
- Return angle of only 5°
- With Take it easy tool finder: colour coding by size

Incredibly compact set arrangement with many tools in a minimum of space. A completely new ratchet set feeling thanks to the unique textile boxes that are very robust and durable. They can be positioned upright for tidy storage on the workshop shelf. Additional surface protection due to textile outer material. Low weight and volume for simpler mobility. "Take it easy" Tool Finder with colour coding according to sizes.



### Web link

[https://products.wera.de/en/zyklop\\_ratchets\\_and\\_accessories\\_the\\_zyklop\\_ratchets\\_the\\_zyklop\\_ratchets\\_1\\_2\\_the\\_zyklop\\_metal\\_ratchet\\_switch\\_1\\_2\\_8100\\_sc\\_8.html](https://products.wera.de/en/zyklop_ratchets_and_accessories_the_zyklop_ratchets_the_zyklop_ratchets_1_2_the_zyklop_metal_ratchet_switch_1_2_8100_sc_8.html)

Wera - 8100 SC 8  
05004078001 - 4013288173881

Wera Werkzeuge GmbH  
Korzter Straße 21-25  
D-42349 Wuppertal  
Tel: +49 (0)2 02 / 40 45-0  
E-Mail: info@wera.de

# 8100 SC 8 Zyklop Metal Ratchet Set with switch lever, 1/2" drive, metric, 28 pieces



## The Zyklop Metal Ratchet Switch, 1/2"

### Set contents:



**8004 C**  
05004064001 1 x 1/2" x 281 mm



**8790 HMC**  
05003601001 1 x 10 x 37 mm  
05003602001 1 x 11 x 37 mm  
05003603001 1 x 12 x 37 mm  
05003604001 1 x 13 x 37 mm  
05003605001 1 x 14 x 37 mm  
05003606001 1 x 15 x 37 mm  
05003607001 1 x 16 x 37 mm  
05003608001 1 x 17 x 37 mm  
05003609001 1 x 18 x 37 mm  
05003610001 1 x 19 x 37 mm



**8794 LC**  
05003638001 1 x 1/2" x 250 mm



**8794 C**  
05003639001 1 x 1/2" x 52 mm



**8784 C2**  
05003641001 1 x 5/16" x 1/2" x 50 mm



**851/2 Z PH**  
05057710001 1 x PH 2 x 32 mm  
05057715001 1 x PH 3 x 32 mm



**867/2 Z TORX®**  
05066901001 1 x TX 20 x 35 mm  
05066900001 1 x TX 25 x 35 mm  
05066905001 1 x TX 30 x 35 mm  
05066910001 1 x TX 40 x 35 mm  
05066915001 1 x TX 45 x 35 mm  
05066920001 1 x TX 50 x 35 mm  
05066902001 1 x TX 27 x 35 mm  
05066925001 1 x TX 55 x 35 mm



**840/2 Z**  
05057515001 1 x 5 x 30 mm  
05057520001 1 x 6 x 30 mm  
05057525001 1 x 8 x 30 mm  
05057530001 1 x 10 x 30 mm

### Web link

[https://products.wera.de/en/zyklop\\_ratchets\\_and\\_accessories\\_the\\_zyklop\\_ratchets\\_the\\_zyklop\\_ratchets\\_1\\_2\\_the\\_zyklop\\_metal\\_ratchet\\_switch\\_1\\_2\\_8100\\_sc\\_8.html](https://products.wera.de/en/zyklop_ratchets_and_accessories_the_zyklop_ratchets_the_zyklop_ratchets_1_2_the_zyklop_metal_ratchet_switch_1_2_8100_sc_8.html)

Wera - 8100 SC 8  
05004078001 - 4013288173881

Wera Werkzeuge GmbH  
Korzter Straße 21-25  
D-42349 Wuppertal  
Tel: +49 (0)2 02 / 40 45-0  
E-Mail: [info@wera.de](mailto:info@wera.de)

The Zyklop Metal Ratchet Switch, 1/2"

Zyklop Metal Switch

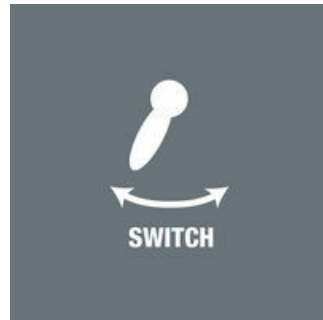

Due to the ever-more confined working environment, space is becoming more and more an issue for the application of ratchets. Our product developers therefore intensively occupied themselves with the issue of confined working spaces, and Wera has now solved this problem. The extremely slim and robust Zyklop Metal ratchet with a long lever was what emerged. When the change in direction needs to be quick, the Zyklop Metal Switch ratchet is the right tool. When the socket must not get lost and a coincidental change of direction has to be avoided at all cost, the Zyklop Metal Push is the correct choice.

Slim design



Forged, full metal ratchet (chrome-molybdenum) that is extremely robust with a long service life; slim design to enable work in very confined spaces.

Reversible



Switch lever for convenient change of direction.

Web link

[https://products.wera.de/en/zyklop\\_ratchets\\_and\\_accessories\\_the\\_zyklop\\_ratchets\\_the\\_zyklop\\_ratchets\\_1\\_2\\_the\\_zyklop\\_metal\\_ratchet\\_switch\\_1\\_2\\_8100\\_sc\\_8.html](https://products.wera.de/en/zyklop_ratchets_and_accessories_the_zyklop_ratchets_the_zyklop_ratchets_1_2_the_zyklop_metal_ratchet_switch_1_2_8100_sc_8.html)

Wera - 8100 SC 8  
05004078001 - 4013288173881

Wera Werkzeuge GmbH  
Korzter Straße 21-25  
D-42349 Wuppertal  
Tel: +49 (0)2 02 / 40 45-0  
E-Mail: [info@wera.de](mailto:info@wera.de)

# 8100 SC 8 Zyklop Metal Ratchet Set with switch lever, 1/2" drive, metric, 28 pieces



## The Zyklop Metal Ratchet Switch, 1/2"

### Small return angle



Fine-pitched with 72 teeth for a return angle of only 5°

### Take it easy tool finder system



Take it easy tool finder system - with profile and size colour-coding for quick and easy tool selection. Colour-coded system for hexagon drive screws (L-Keys, Zyklop bit sockets), external hex drive screws and nuts (Joker wrenches, Zyklop sockets and Zyklop bit sockets with holding function), and TORX® drive screws (L-Keys, Zyklop bit sockets).

### Textile boxes



The textile boxes offer dramatically improved portability, and are space-saving to boot! This means you can now carry the same collection of tools, in a much more compact and comfortable package. The hassle of running back and forth for the right tools has now become a thing of the past. And the much lower weight of a set makes carrying more convenient than ever before. The textile box including the tool will even survive a fall undamaged.

### Secure hold and easy removal

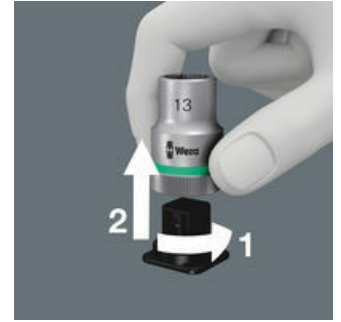

The all new smooth turning mechanism guarantees both secure and rattle-free storage, yet allows easy removal of the tool.

### Web link

[https://products.wera.de/en/zyklop\\_ratchets\\_and\\_accessories\\_the\\_zyklop\\_ratchets\\_the\\_zyklop\\_ratchets\\_1\\_2\\_the\\_zyklop\\_metal\\_ratchet\\_switch\\_1\\_2\\_8100\\_sc\\_8.html](https://products.wera.de/en/zyklop_ratchets_and_accessories_the_zyklop_ratchets_the_zyklop_ratchets_1_2_the_zyklop_metal_ratchet_switch_1_2_8100_sc_8.html)

Wera - 8100 SC 8  
05004078001 - 4013288173881

Wera Werkzeuge GmbH  
Korzter Straße 21-25  
D-42349 Wuppertal  
Tel: +49 (0)2 02 / 40 45-0  
E-Mail: [info@wera.de](mailto:info@wera.de)